

ACCOMMODATION INTERIOR



SEJIN Technical Industries Co., Ltd.

Head office / Factory / Warehouse

15, Eogokgongdan 5-gil, Yangsan-si, Gyeongnam(50591), Korea.
Tel. +82-55-782-1180 Fax. +82-55-782-1001
E-Mail : marketing@sejintec.co.kr
www.sejintec.co.kr

Revision Date : Jan.2021



Challenge towards the Top

Craftsmen to the world's finest ships and Offshore Modules.
Leading company in the maritime field in Korea since 1988.



CONTENTS

DESIGN SOLUTION

P. 03 DESIGN SOLUTION

TURN-KEY PROCEDURE

P. 05 TURN-KEY PROCEDURE

P. 07 CONCEPT & BASIC DESIGN

P. 09 DETAIL DESIGN

P. 11 MATERIAL PROCUREMENT
FOR CONSTRUCTION

P. 13 PREFABRICATION &
ON-BOARD CONSTRUCTION

P. 15 INSPECTION

REFERENCE

P. 17 REFERENCE

QHSE

P. 51 QHSE

CONTACT US

P. 53 CONTACT US

DESIGN SOLUTION

SEJIN performs conceptual & schematic designs, basic designs, detail designs and production designs which fully meet the customer's requirements and the various rule requirements on the basis of know-how and expertise accumulated so far. SEJIN's biggest goal is to offer innovative designs to fulfill both high cost efficiency and environmental requirements of published and expected rules and regulations.



ABOUT US

EPC Solutions for Marine Accommodation

SEJIN provides a Total Solution package that encompasses every technical aspect of a project, based on SEJIN's Advanced shipbuilding and Marine Engineering technology. Prior to a service contract with SEJIN, We provide making engineering for cost reduction, productivity improvement, Etc., And after signing contract, SEJIN provides Maximum value to clients by providing customised services to meet Individual needs.



TURN-KEY PROCEDURE



01 Conceptual & Schematic Design

Early phase of the Accommodation interior design, with concept 3D modeling, CAD drawing, and color selection.

- Proposal for conceptual idea and materials with 3D modeling.
- With feed back from customers for further discussion and modification.
- Outcome of final design concept.

02 Basic Design

To ensure a smooth transition from conceptual design phase to detailed execution and beyond.

- Drawing of Plan, Ceiling plan, Flooring plan, Elevation, etc.
- Submission of drawing for approval before detailed design begins.
- Checking for interference with other necessary parties.



03 Detailed Design

Once a concept and basic design has been thoroughly tested and proven viable, the engineering cycle then moves into fleshing out all the fine details.

- Drawing for Manufacturing of prefabricated items.
- Drawing for on-board installation
- Checking for interference between the detailed drawing and site conditions.

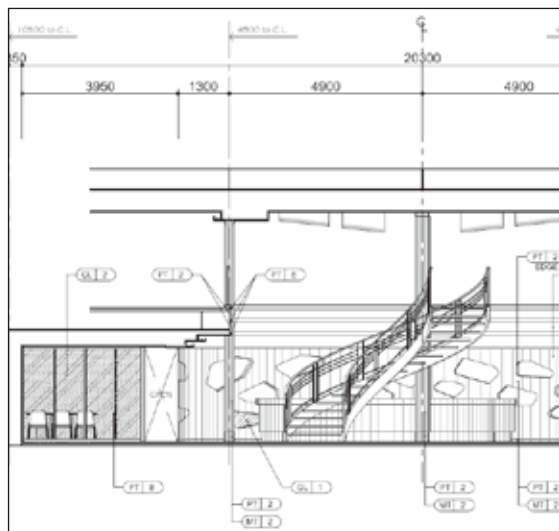

TURN-KEY PROCEDURE



04 Material Procurement for Construction

We manage imported and domestically procured materials to ensure timely progress and minimize unexpected delays.

- Planning and scheduling of procurement. (Domestic and abroad items)
- Inspection before delivery to the site.
- Management and control of delivered items in advance in the warehouse and on-site.

05 Prefabrication & On-board Construction

Once execution of the detailed design has been approved, our management professionals will implement the detailed plan for prefabrication and on-board construction.

- Prefabrication in the shop.
- On-board construction . Pre-firework Insulation Deck covering Wall and ceiling panel installation Installation of equipment Installation of furniture.



06 Inspection

To ensure the quality of on-board construction, inspection is carried out during the cleaning phase.

- Inspection of prefabricated items.
- Inspection after installation on-board.

CONCEPTUAL & BASIC DESIGN

The concept design and basic design are the first starts to introduce SEJIN's design to our Client. This step is the process of choosing the basic structure and color of the interior. SEJIN's know-how, which has accumulated for decades, will come to customer-friendly design. SEJIN's intuitive and elegant design proudly captures the hearts and minds of its customers.



TURN-KEY PROCEDURE



- 1 ENGINEERING OPERATION**
AUTO CAD, AM, 3D MAX, Sketchup, and other programs are used by professional designers for interior design work.
- 2 COLOR SCHEME**
Based on various materials and colors, We provide services that satisfy our customers.
- 3 CONCEPT DESIGN**
We provide basic design and concept design in accordance with the purchase requisition, and we provide a design to a client.

DETAILED DESIGN

Once a concept and basic design has been thoroughly tested and proven viable, the engineering cycle then moves into fleshing out all the fine details. These steps include drawing for manufacturing & on-board installation and checking for interference on site condition.



TURN-KEY PROCEDURE



1 LIGHTING DESIGN ARRANGEMENT
Square & red type lighting box to produce space.

3 LINE LIGHTING DESIGN
Utilizing the features of metal and creating space using line lighting.

5 SELF DESIGN
Detailed design expressed by a bookshelf by combining the glass monotony and the splendor of metal.

2 LIGHTING DESIGN ARRANGEMENT
Utilizing circular crystal lighting, creating a warm and warm space.

4 HANDRAIL DESIGN
Detailed design expressed by a bookshelf by combining the glass monotony and the splendor of metal.

6 STAIRSWAY
Combining the elegance of curves and the splendor of forging follow represent space.

MATERIAL PROCUREMENT FOR CONSTRUCTION

SEJIN not only provides an integrated "EPC solutions" that require high performance and proven design but also offers you the most competitive and reliable equipment and material package.



TURN-KEY PROCEDURE



1 RAW MATERIAL PROCUREMENT

Through decades of experience, SEJIN can get a variety of materials. After raw materials arrive, Quality Control is performed so as not to cause defective rate.

2 STORAGE

We operate own warehouse to keep it safely stored until delivery. This content is in accordance with ISO 9001.

3 ON-TIME DELIVERY

Various packaging methods are available depending on its the product, and real-time monitoring makes on-time delivery.

PREFABRICATION & ON-BOARD CONSTRUCTION

Pre-fabrication to consider item manufacturing and construction process management.
In case of a large item, SEJIN plan to be constructed at the factory first.
So that it can be assembled and be installed at the minimum term of work times during site installation.



TURN-KEY PROCEDURE



1 FOUNDATION INSTALLATION

Considering the internal environment of the ship, SEJIN possesses the know-how of construction and construction of leading equipment suitable for each item construction.

2 IN-PLANT ASSEMBLY AND ONBOARD INSTALLATION

Large-sized products that can not be installed directly in the ship separated its parts and then assembled on site.

3 CABIN INSTALLATION

In the case of Prefabricated cabin construction, the construction is done in the following order.
Located the wet unit - Assemble the wall - Install Ceiling panel - install cabin door - install the furniture - install the electrical equipment and cables - inspection and test - packing - move storage

INSPECTION

Inspection refers to business trip inspection, receipt inspection, process inspection, final inspection from the time of receipt to delivery of raw materials, auxiliary materials, various parts, semi-finished products, and finished products related to quality. Inspection is based on the customer's standard drawings and specifications, and all procedures are carried out according to ISO 9001.



TURN-KEY PROCEDURE



1 MATERIAL INSPECTION

All products except customer's goods will be accepted only for products passed through the goods receipt and business trip inspection, and the rejected products will be returned. For customer-supplied items, SEJIN separate tags and making them for storage.

2 PRODUCT INSPECTION

After the final inspection and testing of the products manufactured by SEJIN, the quality control team completes the inspection test by the approval of the customer and the external organization or the sign of the head of the quality control team.

3 A STRICT QUALITY CONTROL SYSTEM

SEJIN has a diverse range of business range from small types of furniture such as sofas and chairs to panels, prefabricated cabins, and interior furnishings. Because SEJIN handles all the products, the product completeness is excellent.

PERFORMANCE RECORD



PERFORMANCE RECORD

Performance Record

RECENT PERFORMANCE STATUS

Updated on JAN. 2021

S/N	OWNER	TYPE	CLASS	RULE & REGULATION	SHIPYARD	DELIVERY
1	ENI CORAL	FLNG	LR	SOLAS NORSOK STANDARD	SHI (KOREA)	IN PROGRESS (2021)
2	HYDEX	RO-PAX	KR	SHIP SAFETY ACT	HMD (KOREA)	IN PROGRESS (2021)
3	MALAYSIAN NAVY	LITTORAL COMBAT SHIP	BV	SOLAS	BOUSTEAD NAVAL (MALAYSIA)	IN PROGRESS (2021)
4	PUKYONG Nat'l Univ.	TRAINING SHIP	KR	SHIP SAFETY ACT	DAESUN (KOREA)	Dec.2020
5	INDIAN COAST GUARD	PATROL VESSEL	ABS	SOLAS	GOA (INDIA)	May.2020
6	WEIDONG FERRY	RO-PAX	KR	SOLAS PASSENGER GRADE	HMD (KOREA)	Sep-2018
7	SEADRILL	DRILL SHIP	DNV.GL	SOLAS	DSME (KOREA)	Jul.2018
8	INPEX	FPSO	DNV.GL	NORSOK STANDARD	DSME (KOREA)	Jan.2018
9	SHELL	FLNG	DNV.GL	SOLAS MODU, AMSA	SHI (KOREA)	Jun.2017
10	INPEX	CPF	DNV.GL	NORSOK STANDARD	SHI (KOREA)	Apr.2017
11	SUBSEA 7	HCV	LR	SOLAS ICE CLASS 1D	HHI (KOREA)	Feb.2017
12	EDDA	ACCOMM. VESSEL	DNV.GL	DNV COMF V(1)	HHI (KOREA)	May.2016

PERFORMANCE RECORD

Updated on JAN. 2021

SHIPBUILDING YARD	SHIP
SAMSUNG HEAVY IND. CO., LTD.	6
SEKWANG HEAVY IND.	19
DAEWOO SHIPBUILDING & MARINE ENGINEERING CO., LTD.	13
KANGNAM CORPORATION.	3
HYUNDAI HEAVY IND. CO., LTD.	12
HYUNDAI MIPO DOCKYARD CO., LTD.	3
HANJIN HEAVY IND. CO., LTD.	3
STX OFFSHORE & SHIPBUILDING	4
OTHER SHIPYARDS	16
TOTAL	79

REFERENCE



WEIDONG FERRY RO-PAX

• SHIP OWNER	WEIDONG FERRY
• SHIP TYPE	RO-PAX
• CLASS	KR
• RULE & REGULATION	SOLAS PASSENGER GRADE
• SHIP YARD	HMD
• DELIVERY	SEP-2018



REFERENCE

Reference



WEIDONG FERRY RO-PAX



REFERENCE

Reference



REFERENCE



INPEX CPF

• SHIP OWNER	INPEX
• SHIP TYPE	CPF
• CLASS	DNV/GL
• RULE & REGULATION	AUSTRALIAN CODES & STANDARDS
• SHIP YARD	SHI
• DELIVERY	APR-2017



REFERENCE

Reference



INPEX CPF



DINING ROOM



QUIET LOUNGE



AUDITORIUM

REFERENCE

Reference



SHAKE BAR



COFFE BAR



CHANGING ROOM

REFERENCE



RECREATION ROOM

SHELL FLNG

• SHIP OWNER	SHELL
• SHIP TYPE	FLNG
• CLASS	DNV.GL
• RULE & REGULATION	SOLAS MODU, AMSA
• SHIP YARD	SHI
• DELIVERY	JUN-2017



REFERENCE

Reference



MESS ROOM



RECREATION ROOM



HELICOPTER ROOM

SHELL FLNG



REFERENCE

Reference



REFERENCE



INPEX FPSO

• SHIP OWNER	INPEX
• SHIP TYPE	FPSO
• CLASS	DNV.GL
• RULE & REGULATION	AUSTRALIAN CODES & STANDARDS
• SHIP YARD	DSME
• DELIVERY	JUL-2017



REFERENCE

Reference



INPEX FPSO



REFERENCE

Reference



REFERENCE



EDDA ACCOMMODATION VESSEL

• SHIP OWNER	EDDA ACCOMMODATION
• SHIP TYPE	ACCOMMODATION VESSEL
• CLASS	DNV.GL
• RULE & REGULATION	DNV.GL COMFORT CLASS V(1)
• SHIP YARD	HHI
• DELIVERY	MAY-2016



REFERENCE

Reference

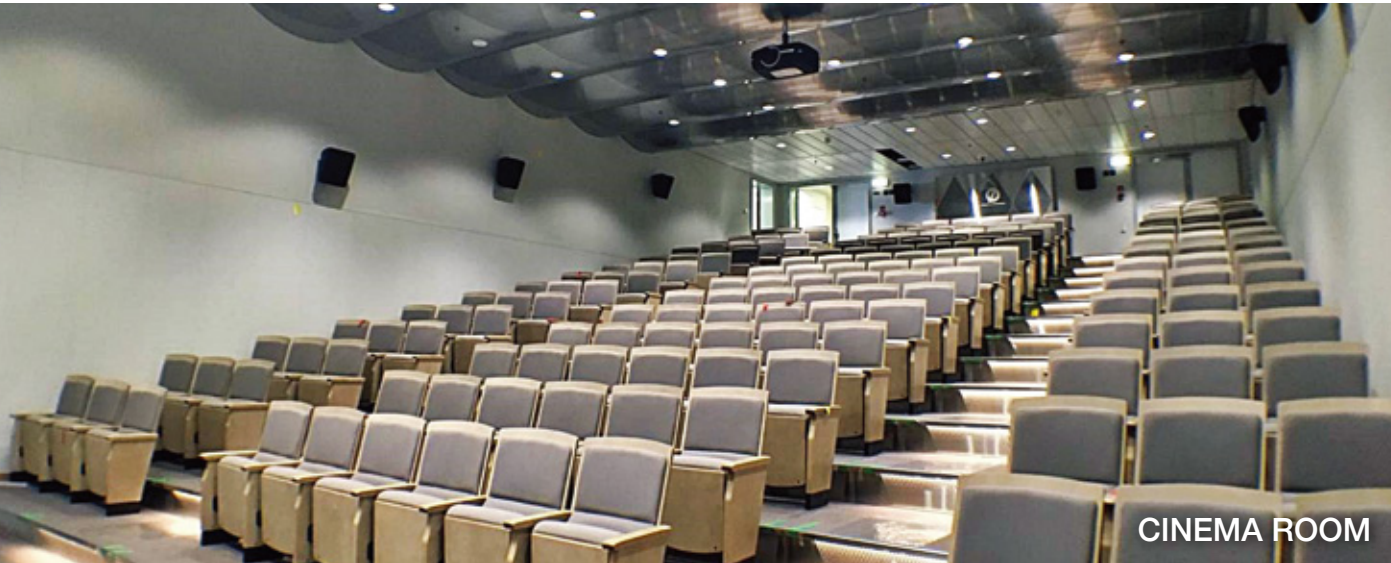

EDDA ACCOMMODATION VESSEL



REFERENCE

Reference



REFERENCE



BAR LOUNGE

COTUNAV RO-PAX

• SHIP OWNER	COTUNAV
• SHIP TYPE	RO-PAX
• CLASS	KR
• RULE & REGULATION	SOLAS PASSENGER GRADE
• SHIP YARD	DSME
• DELIVERY	MAY-2012



REFERENCE

Reference



MOORISH CAFE



MAIN RESTAURANT



MEZZANI BAR

COTUNAV RO-PAX



REFERENCE

Reference

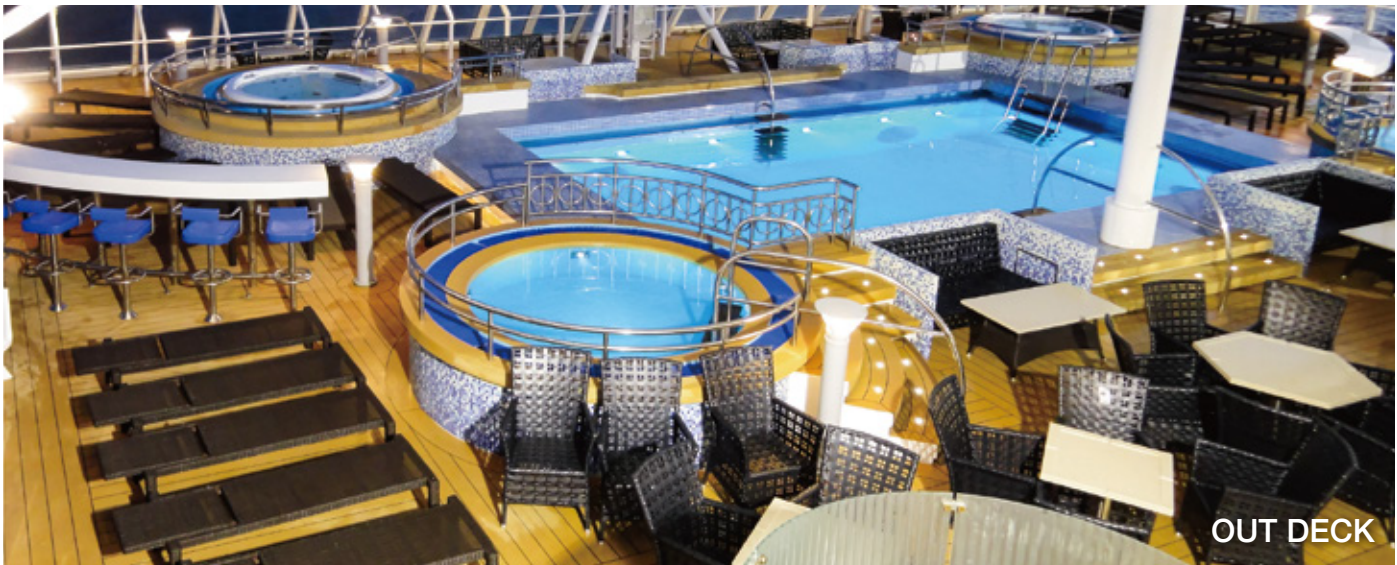

REFERENCE



MAIN RESTAURANT

BLUESTAR FERRY RO-PAX

• SHIP OWNER	BLUESTAR FERRY
• SHIP TYPE	RO-PAX
• CLASS	BV
• RULE & REGULATION	SOLAS PASSENGER GRADE
• SHIP YARD	DSME
• DELIVERY	MAR-2003



REFERENCE

Reference



BAR LOUNGE



RESTAURANT



CORRIDOR

REFERENCE



MINOAN LINE RO-PAX

• SHIP OWNER	MINOAN LINE
• SHIP TYPE	RO-PAX
• CLASS	GL
• RULE & REGULATION	SOLAS PASSENGER GRADE
• SHIP YARD	SHI
• DELIVERY	APR-2001



REFERENCE

Reference



REFERENCE



SPORTS BAR

MOBY LINE RO-PAX

• SHIP OWNER	MOBY LINE
• SHIP TYPE	RO-PAX
• CLASS	RINA, ABS
• RULE & REGULATION	SOLAS PASSENGER GRADE
• SHIP YARD	DSME
• DELIVERY	MAR-2001



REFERENCE

Reference



RESTAURANT



PIZZA BAR



LOBBY

REFERENCE



DINING ROOM

PUKWAN FERRY RO-PAX

• SHIP OWNER	PUKWAN FERRY
• SHIP TYPE	RO-PAX
• CLASS	KR
• RULE & REGULATION	SOLAS PASSENGER GRADE
• SHIP YARD	HMD
• DELIVERY	MAR-2002



REFERENCE

Reference



NIGHT CLUB



BAR LOUNGE



LOBBY LOUNGE

Q (Quality Management)

SEJIN has always been built around a singular vision: to create every space that is as durable and functional as they are beautiful and intuitive. SEJIN is a stunning realization of that ideal. All the elements that define marine accommodation have been thought and engineered, so SEJIN provides you to meet the vibrant daily life in comfortable space. And all these things were reflected by SEJIN's know-how, originality, and craftsmanship accumulated over many years.



■ Quality Management System

SEJIN has defined the core value of quality management as “Customer Satisfaction”. We set up and have been operating a systematic quality management system for continual improvement and innovation.

As the world's leading Total Marine Accommodation turnkey provider, we pursue to create the highest value and share deep trust with our customers.



ISO 9001 : 2015

HSE (Health, Safety and Environment)

■ Our Mission

The Shipbuilding and Offshore industry can have a significant impact on the environment. We recognize our responsibility to contribute to a sustainable development of the industry.



ISO 14001 : 2015

■ Zero Incidents.

Health and Safety is at the core of our operations and we strive to maintain our achievement of zero incidents. We do everything possible to ensure the safety of our employees, customers, subcontractors and other parties.

■ Practice

Practice sustainable improvement for the environment, health and safety improvements through prevention activities on environmental pollution, injury and accident, occupational diseases

■ Customer Satisfaction

Customer Satisfaction is our top priority. Leveraging our top-notch technology capabilities and human resources, extensive experience, and know-how, we go to great lengths to deliver a higher level of Satisfaction to our customers. Our rich history of accomplishments made throughout the world is evidence of our Strong Commitment to providing the most innovative and stable solutions through proactively responding to changes in the market and project variables.

■ Our Goal

Establishing goals and sustainable plans for continuous improvement relating to preventing environmental accidents, injuries and health hazards.

■ Responsibility

Corporate responsibility objectives are intergrated into our internal governance system and are closely linked to our business activities.



OHSAS 45001 : 2018

CONTACT US

Ideal Locations for Global Marine Business Operation



Supporting everywhere in the world

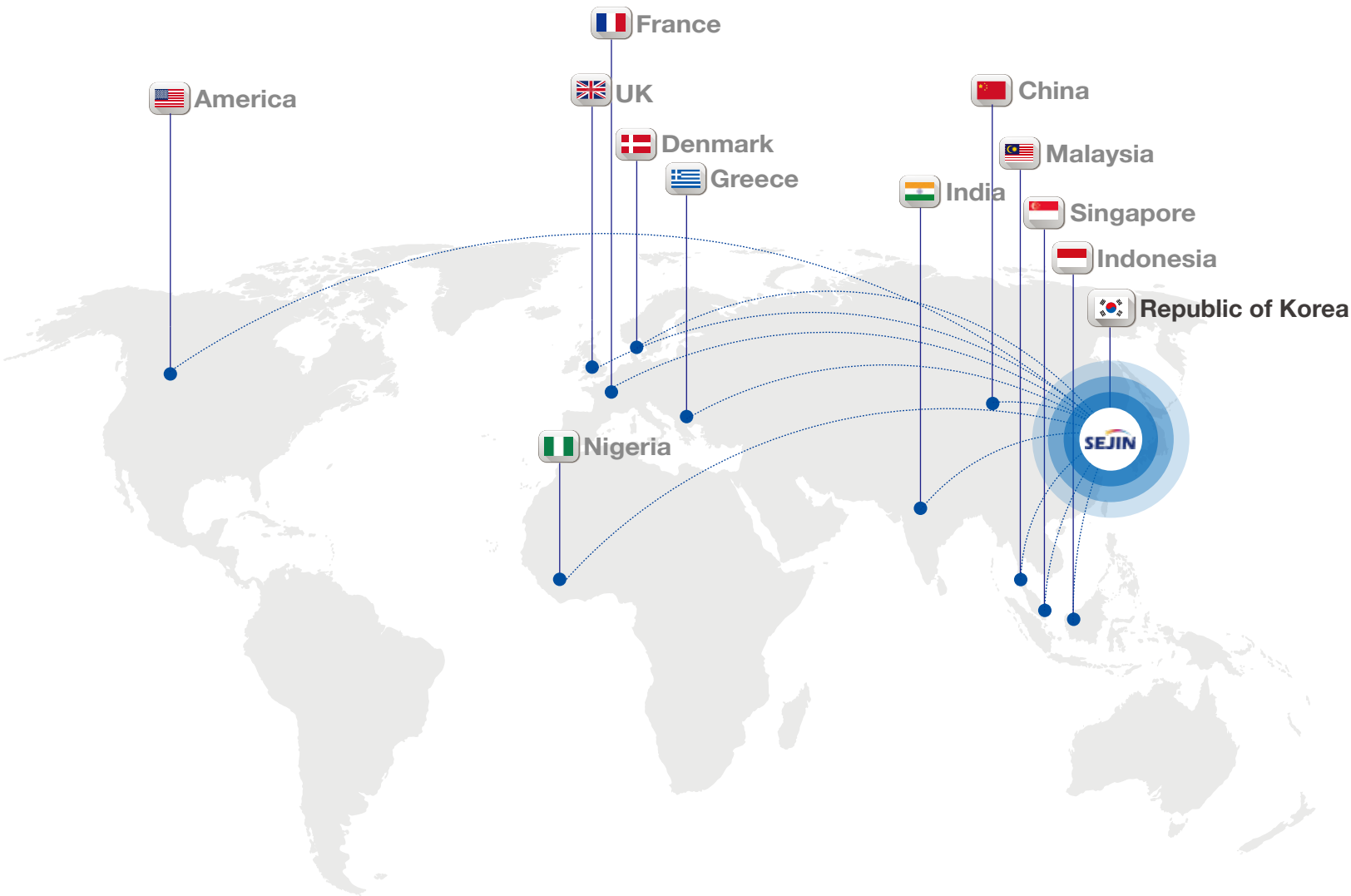

■ **Head office / Factory / Warehouse**
15, Eogokgongdan 5-gil, Yangsan-si, Gyeongnam(50591), Korea.
Tel. +82-55-782-1180 Fax. +82-55-782-1001
E-Mail : marketing@sejintec.co.kr
www.sejintec.co.kr

